

## CEPRO PVC CLEAR CURTAIN

### TECHNICAL DATA

Maximum length 2 meter, produced from tube of 35mm Ø. This product is finished with a grey (RAL 7035) powdercoating. Fitted with a mechanical hinge and an assembly plate for fixing the arm against a wall or column.

Radius	: 208cm
Range	: 180 °
Height	: 36cm
Max. static load	: 190 N
Max. dynamic load	: 250 N
Control	: manually

### DIMENSIONS

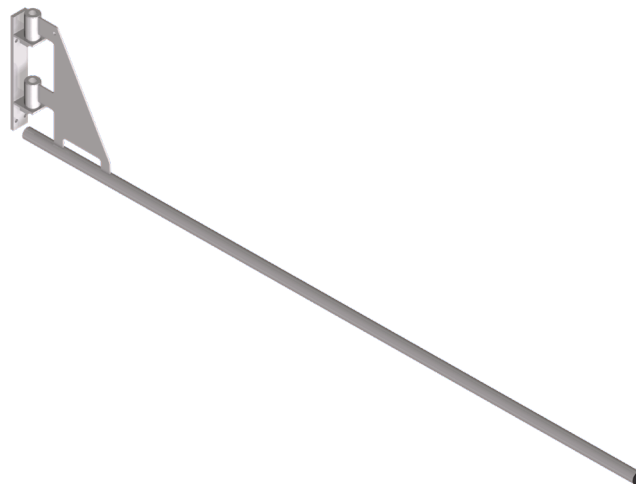
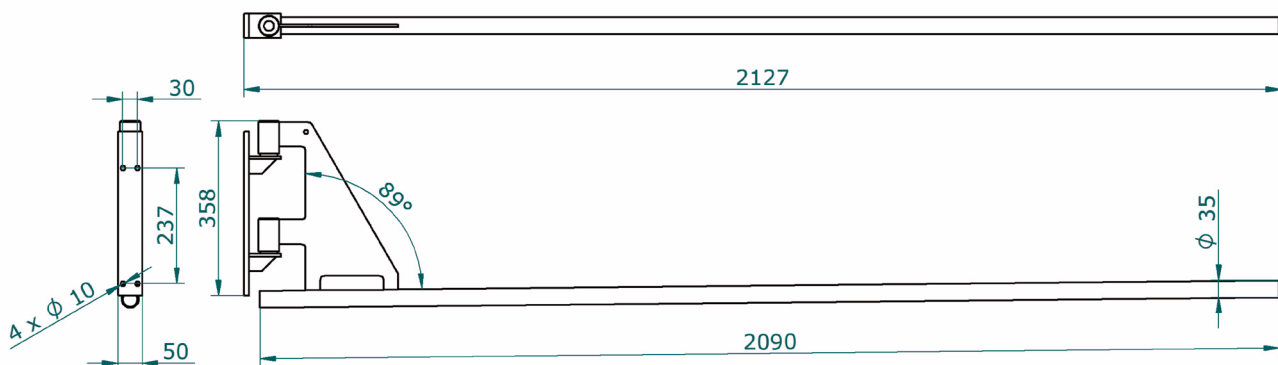

## CEPRO PIPE SWIVELARM

### COMPOSITION

Carbon steel parts, powder coated.  
 Contain no toxic parts.  
 Contain no inflammable parts.  
 Contain no electrical parts.

### USE AND HANDLING

Coating will be damaged by open fire or intensive heat.

### MAINTENANCE AND SAFETY

- The assembly plate is provided with holes Ø10 mm for mounting to a solid wall of column which can withstand larger forces.
- It is absolutely important that bolts periodically must be checked at free assembly.
- Turning axis's must be greased for optimal function. Interval depends of intension of use.
- Weld seams must be visual periodic inspected on cracks.
- Arm may not be overload the maximum indicated weight.
- Arm is only suitable for use of strip, curtain or blanket separation. It is not recommended for hoisting operations.

### COMBINATION SWIVEL ARM AND COLUMNS / POLES

Orders for swivel arms (for strips or curtains) which will be fixed onto one of the CEPRO columns or poles, will only be delivered in the combinations as mentioned below

82.10.15 Swivel arm length 200cm	Curtain			Strips 300 x 2 mm			Strips 300 x 3 mm		
	Heigth under beam			Heigth under beam			Heigth under beam		
	1,85 mtr	2,10 mtr	2,60 mtr	1,85 mtr	2,10 mtr	2,60 mtr	1,85 mtr	2,10 mtr	2,60 mtr
	83.10.01.0225 50x50x2mm H=2,25 mtr	83.10.01.0250 50x50x2mm H=2,50 mtr	83.10.01.0300 50x50x2mm H=3,00 mtr	83.10.01.0225 50x50x2mm H=2,25 mtr	83.10.02.0250 80x80x3mm H=2,50 mtr	83.10.02.0300 80x80x3mm H=3,00 mtr	83.10.02.0225 80x80x3mm H=2,25 mtr	83.10.02.0250 80x80x3mm H=2,50 mtr	on request